



EXTRA-DUTY WEATHER RESISTANT PANEL MOUNT HOUSING (M8)

Designed for wet or damp locations, Extra-Duty M8 Thru-View® Housings allow customers to plug items into their customized GracePort® and close the cover to provide in-use protection against rain and moisture.

The NEC recognizes that most residential in-use receptacle covers are not suitable for commercial and industrial usage. In these applications they describe an industrial in-use cover as extra-duty. Built for long life, the industrial M8 extra-duty housing fits this need.

The extra-duty in-use cover requirement applies to devices plugged into 15-20 Amp/125-250Volt receptacles in wet or damp locations unattended by the worker. Wet locations are subject to routine high pressure spray then a standard UL Type 4/4X Thru-View® should be used.

MOUNTING DIMENSIONS INCHES (MM)

| HOUSING CODE | WEIGHT (OZ) | A | B | C | D | EØ |
|--------------|-------------|-----------------------------|----------------------------|-----------------------------|----------------------------|--------------------------|
| M8 | 17.6 | 4.80 ± .010 (122.0 ± .2) | 3.15 ± .010 (80.0 ± .2) | 5.83 ± .004 (148.0 ± .1) | 2.76 ± .004 (70.0 ± .1) | .26 ± .010 (6.5 ± .2) |

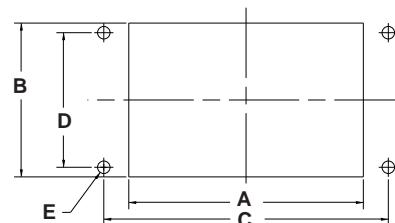

OVERALL DIMENSIONS INCHES (MM)

| HOUSING CODE | F | G | H | I | K | L | MØ | NØ |
|--------------|-----------------|----------------|-----------------|-----------------|-----------------|----------------|-----------------------|--------------------------|
| M8 | 6.50 (165.0) | 3.78 (96.0) | 5.02 (127.6) | 4.59 (116.7) | 9.03 (229.4) | 0.57 (14.4) | .45 .20 (11.5 5.2) | .26 ± .004 (6.5 ± .1) |

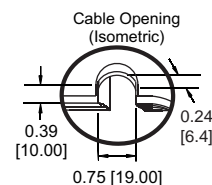
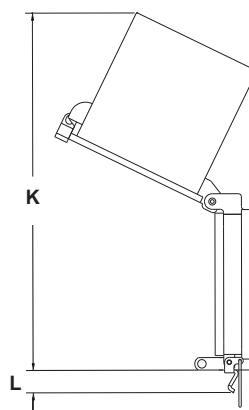
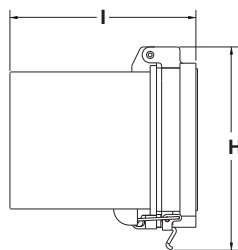
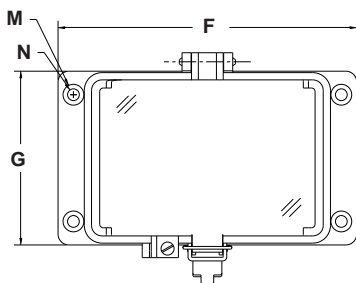

Warning: Verify an electrical conductor has been de-energized using an adequately rated test instrument before working on it. Follow appropriate Energy Control (Lockout/Tagout) procedures as per OSHA Subpart S.

© Grace Engineered Products, Inc. All rights reserved. Specifications are subject to change with/without notice.



Certification based on final product.

GP-M8-DS-EN 2006